

LED Power Driver 20 W

Optimal choice for refrigerated cabinets and display lighting



LED Power Driver 80 W

Philips Xitanium Constant Voltage Outdoor LED drivers

These Xitanium Constant Voltage Outdoor LED drivers are the perfect choice for enabling easy modular parallel connection of Philips LED products (like LDM and InteGrade families) used in refrigerated cabinets and display lighting. The drivers have an operating life matching that of LEDs. They offer excellent reliability and ensure a simplified installation process. Robust design reduces maintenance and lowers the cost of ownership over the application lifetime. With the universal mains voltage (100-240 V) you can install them in practically any location. All types have been tested according IP 54.

Benefits

- SELV operating voltages ensure safety even if wiring or LED boards become damaged
- Easy installation with simple parallel wiring
- Excellent reliability

Product features

- Universal mains voltage (100-240 V) generating 24 VDC
- Stable limited output voltage
- Safety Extra Low Voltage (SELV)
- Short circuit protection
- Lifetime upto 50.000 hours

Applications

- Shelf and linear accent lighting in supermarkets, refrigerated cabinets, retail environments, libraries, museums

Compliance and approvals

- CE
- UL
- CSA
- VDE¹
- IEC 60335-2-89

Notes:

1. Not on 80 W 24 V

Product specifications

Input				
parameter	Symbol	20 W-24 V driver	80 W-24 V driver	Unit
Input voltage range	V_{in}	100-240	100-240	V
Frequency	f	47-63	47-63	Hz
Power consumption range	P_{in}	25 max.	96 max.	W
Power factor*	Pf	0.9 min	0.9 min	
Total harmonic distortion	THD	20	20	%
Efficiency*	-	80% typical	80% typical	%

* at full load

Output				
parameter	Symbol	20 W-24 V driver	80 W-24 V driver	Unit
Output voltage range	V_{in}	23-25.6	23-25.6	V
Output current	I_a	0.85	3.3	A
Output voltage ripple	-	1.0	1.0	%
Short circuit protection	-	yes	yes	-

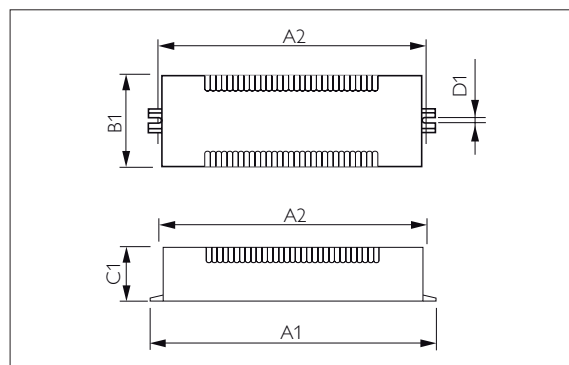

Dimensions Philips LED Power Driver 20 W

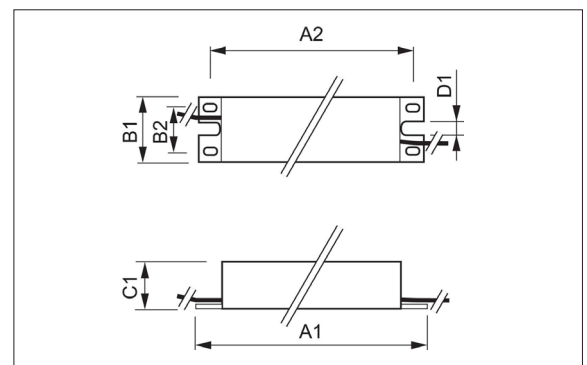

Dimensions Philips LED Power Driver 80 W

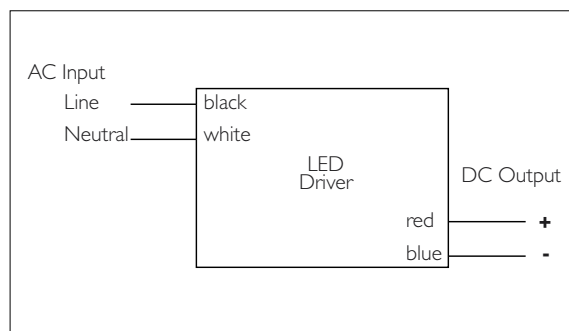

Wiring diagram of the 20 and 80 W LED Power Driver.

Dimensions in mm

Driver type	A1	A2	B1	B2	C1	D1
20 W	140.0	130.0	37.0	-	25.0	4.4
80 W	241.0	228.6	43.1	26.6	30.0	4.4

Notes:

1. Drawings are not to scale.
2. Two mounting slots for M4 or #6 screws.
3. Lead wires: 300 mm length, 0.8 mm² solid-core copper.

Ordering info

Type	Qty. box packing (pcs)	12NC	European Order Code (EOC)
LED Power Driver outdoor 100-240V 20W 24V	10	9290 006 54006	871829121524000
LED Power Driver outdoor 100-240V 80W 24V	10	9290 006 53906	871829121526400



© 2012 Koninklijke Philips Electronics N.V.

All rights reserved. Reproduction in whole or in part is prohibited without the prior written consent of the copyright owner. The information presented in this document does not form part of any quotation or contract, is believed to be accurate and reliable and may be changed without notice. No liability will be accepted by the publisher for any consequence of its use. Publication thereof does not convey nor imply any license under patent- or other industrial or intellectual property rights.

08/2012

www.philips.com/ledrefrigeration