

Camillo

LED



AC600LEDHH

Camillo is a traditional post-top luminaire for garden, available in LED and discharge lamp models. Camillo can be used in various outdoor applications like large gardens and market squares, pedestrian areas, parks, parking areas and playgrounds.

DALI

DALI drivers enable luminaires to be connected to DALI based control systems and Smart Buildings. Compared to a fixed output installation, the dimming and individual control capability provided by DALI enables considerable energy savings and control, depending on luminaire specifications.

BaseDim

Ensto BaseDim -solution makes energy saving easy without compromising safety or area lighting. BaseDim drops light output 50% during 8 hours in dark time. It's automatic and simple, but gives you benefits in energy saving.



"Traditional beauty
available also in LED."



AC600LEDM

35W 3060 lm

Structure

- White anti-glare rings powder-coated aluminium
- In LED-models acrylic frosted diffuser inside the anti-glare rings
- Diffuser shock and uv resistant polycarbonate
- Hat used as reflector and base of the luminaire power coated aluminium
- Integrated gear tray inside the luminaire body
- Camillo LED:
Connected load 35W, luminaire luminous flux 3060 lm
4000 K, Ra > 70, power factor 0,98
Ambient temperature - 25 °C - + 30 °C
LED-module lifespan 50 000 h (L70), T_a = 25 °C
With Bi-power function. The luminaire switches automatically (factory setting) to lower power level 50% for 8 hours. (3 hours before and 5 hours after the calculated midnight)

Mounting

- On ø 60 mm column or stepped column ø 60 mm
- Recommended mounting height 3-5 m
- LED-models with connection lead 4,5 m VSKN 3x1,5 mm² included in the delivery

Made to order

- LED-models with DALI
- Special colours
- Columns from Tehomet selection:
Stepped columns Conical columns
OH3/108 + colour KH3/108 + colour
OH4/108 + colour KH4/108 + colour
OH5/108 + colour KH5/121 + colour
OH6/108 + colour KH6/136 + colour
Colours: RAL 9006 (pearl grey) and RAL 9011 (black)
O = stepped columns, K = conical columns
H3 = height above the ground (f.ex. 3 m) /108 = diameter of the base
Top of the column is always ø 60 mm.
Besides the height above the ground to the overall height of column an additional + 500 mm is calculated, which goes to base. All columns have a coupling space. Surface-treatment hot dip galvanized and power coated.
- SK-6 wall arms available for wall installations
- Helvar NightDim

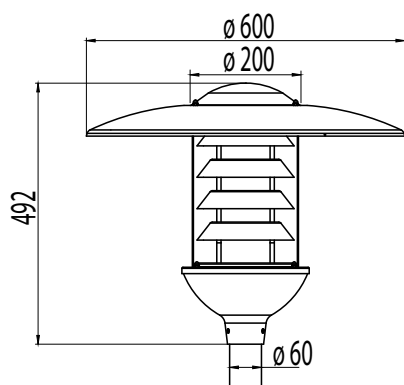

Camillo LED

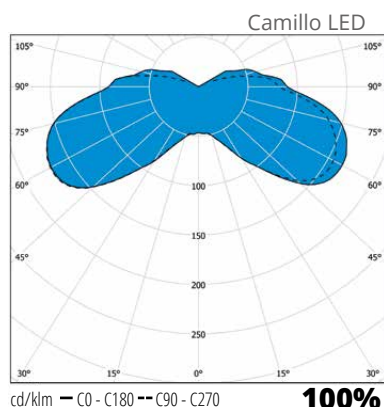

| E Number | Type | Product name | Base | Colour | Kg |
|--|--------------|-------------------------------|-----------------|------------------------------|------|
| Camillo LED | | | | | |
| 45 030 77 | AC600LEDHH | AC600LEDHH 35W/840 FAC HH | LED | grey/white anti-glare rings | 5,5 |
| 45 030 79 | AC600LEDM | AC600LEDM 35W/840 FAC MU | LED | black/white anti-glare rings | 5,5 |
| Camillo LED with Bi-power power reduction | | | | | |
| 45 030 98 | AC600LEDBPHH | AC600LEDBPHH 31W/840 BP AC HH | LED | grey/white anti-glare rings | 5,5 |
| 45 030 99 | AC600LEBPDM | AC600LEDBPM 31W/840 BP FAC MU | LED | black/white anti-glare rings | 5,5 |
| Columns ø 60 mm | | | Height m | | |
| 46 031 00 | VP350060/M5 | VP350060/M5 3.5M 60MM GR | 3,5 | grey | 10,2 |
| 46 031 03 | VP350060/M2 | VP350060/M2 3.5M 60MM BK | 3,5 | black | 10,2 |
| 46 031 06 | VP350060/M1 | VP350060/M1 3.5M 60MM WH | 3,5 | white | 10,2 |

